

PBRERA-SAS79-PR0896



MAYFAIR PARK

3 & 2 BHK

Luxury Residences

UNPARALLELED, EXTRAORDINARY



AND EVERYTHING IN BETWEEN



LIVE SIGNATURE LIFE STYLE

IT'S MEANT FOR THOSE RARE CLASS
OF INDIVIDUALS WHO UNBELONG TO
THE ORDINARY, WHO DESERVE ONLY
THE UNPARALLELED.

IT'S BUILT FOR THOSE WHO HAVE AN AFFINITY
FOR QUALITY AND AN UNCOMPROMISING ATTITUDE
TOWARDS ALL THINGS FINE.

IT'S CRAFTED FOR THOSE WHO BELIEVE
THAT LIFE IS WORTH LIVING TO THE FULLEST.



DISCOVER
THE PINNACLE
OF LUXURY
LIVING

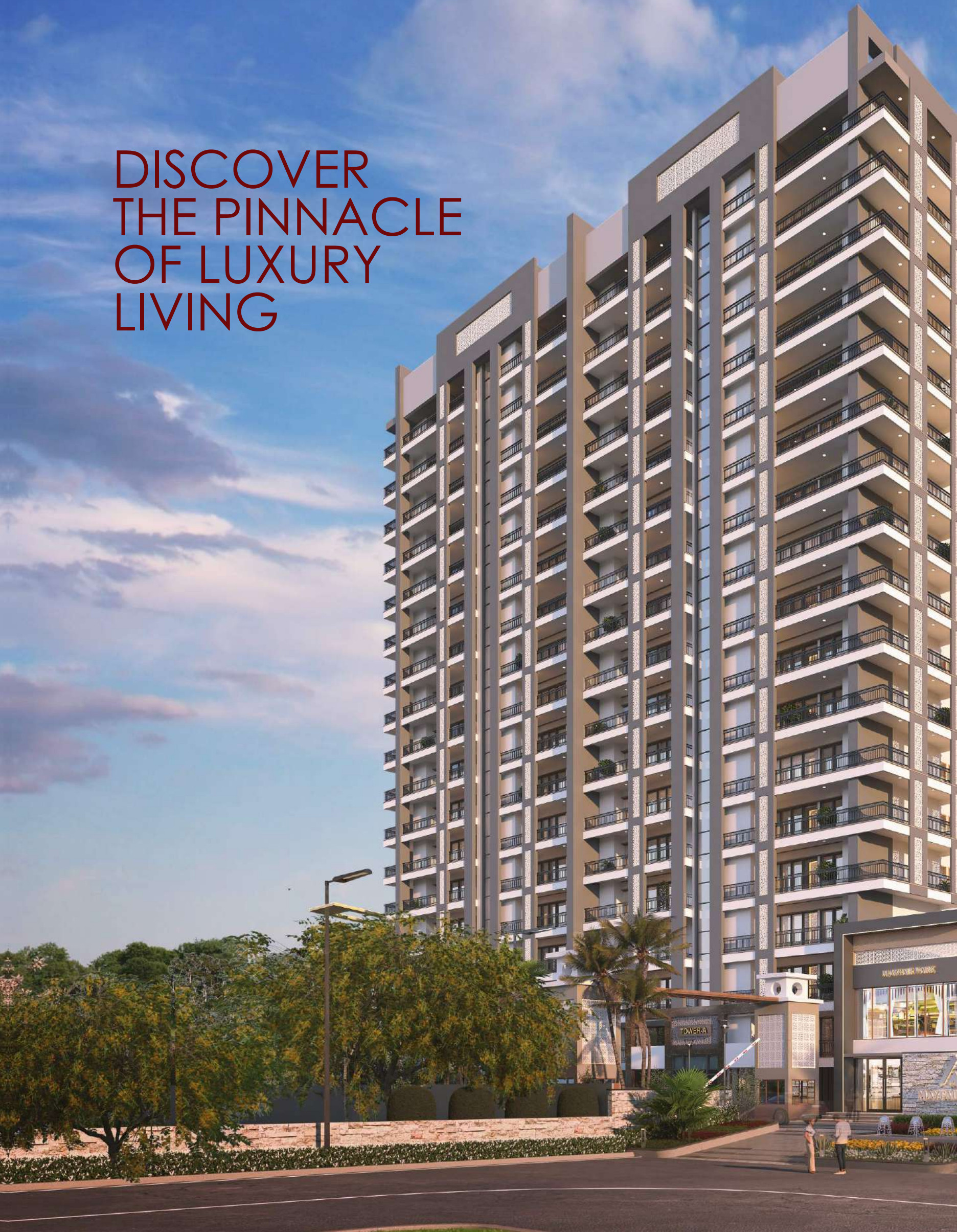



EVERY DETAIL EXUDES PRESTIGE AND REFINEMENT AT MAYFAIR PARK



Mayfair Park presents the Signature Style Life. It brings forth a lifestyle for those who have a fine taste for life and exclusivity. Step into a home that blends innovation with style creating contemporary spaces that are a class apart. Discover a landscaped garden that encompasses a galore of recreation amenities. Elevate to the terrace level and experience a host of features that's beyond the earth. At Mayfair Park, live the signature life at the new peak of luxury.

- S+17 storey magnificent tower
- 2, 3 BHK air-conditioned residences with home automation (optional*)
- 15,000 sq. ft. landscaped garden
- Extra Ordinaire clubhouse & mega gym
- Unrestricted views of the mountains from every flat
- Gated community with hi-tech 24X7 surveillance
- Situated in the prime location near to sector 20, Panchkula
- Ample parking space and surface basement

THE PROJECT

2 & 3 BHK
LUXURY
RESIDENCES



SOULFUL INDULGENCES, SOOTHING EXPERIENCES AND THE REJUVENATION



EXTRAORDINAIRE RESTAURANT, CLUBHOUSE & MEGA GYM

When we say signature style, we really mean it ! A well thought out and an appealing set up has been planned for the Clubhouse and restaurant to make the evenings and pleasure moments memorable.



LAVISH
RESTAURANT



INDOOR
SWIMMING
POOL



MODERN
GYM &
HEALTH CLUB



INDOOR
GAMES

RHYTHM, LAPS AND THE BEST OF COMMON AMENITIES



- Total Green Area 15,000 Sft with 10,000 sq ft of central green with Badminton, Yoga / Meditation Area and kids activity area
- 2 & 3 side Open Flats
- Mivan Construction
- All Units Park Facing
- Dual Flat Core
- Club House
- Car Parking in basement, surface and in Stilt
- Security room and area for resident welfare association



YOUR HOME IS WHERE YOU EMBRACE YOUR TRUE SELF



The residences at MAYFAIR PARK are beautifully tucked away from the madness of the city. Yet, they are close to every need you wish attended to. Strategically located at Peer-muchalla and in close proximity to sector 20, Panchkula, these residences give you immediate access to the best this place has to offer. From the best options in retail and commercial developments to schools, a bustling office hub, hospitals, colleges and world class recreational options.



LIFESTYLE AMENITIES



RESIDENCE ZONE



PLAY ZONE



BASKET BALL COURT



CLUB ZONE



RELAX ZONE



24/7 CCTV surveillance with Recording, Video Doors Phones in every flat
Digital Smart Lock with fingerprint / pass code/ mobile access in each flat



EV CAR CHARGING POINT



CCTV SURVEILLANCE



24X7 3-TIER SECURITY





A DISTINGUISHED
ADDRESS YOU
CALL YOUR OWN

SIGNATURE STYLE, SUPERIOR LIFESTYLE

YOU OFTEN COME ACROSS PEOPLE WHO ARE DIFFERENT,
AND WHEN THEY MEET ANYONE, THEY LEAVE BEHIND
AN UNFORGETTABLE IMPRESSION AND A REMARKABLE SIGN,
THEIR SIGNATURE.



EVERY DETAIL EXUDES
PRESTIGE AND REFINEMENT
AT MAYFAIR PARK





PROVIDING YOU WITH SPACES THAT GIVE YOU RELAXATION

GREEN LANDSCAPE AREAS TO UNWIND AND ENJOY THE WAY YOU LIKE

A fit body is all you need to face whatever tough situations that life throws at you. Jog or walk through the vast green areas for a fit min, body and soul. Here you'll start to discover the advantages of an active life.



THE ESSENCE OF LUXURY IS YOUR DAILY COMPANION AT MAYFAIR PARK

DISCOVER THE PINNACLE OF LUXURY LIVING

Mayfair Park stands as a testament to uncompromising luxury, an oasis where architectural brilliance meets a world of opulence. Step into a realm where every detail has been meticulously crafted to resonate with the essence of grandeur.



PLEASURE MOMENTS, AND GOODNESS OF ACTIVE LIFE

EXTRAORDINARY &
EXCLUSIVITY IS A FEELING
YOU WILL GET USED TO



SOULFUL INDULGENCES
AND LUXURY LIVING IS
WOVEN INTO THE EVERY
FABRIC OF LIFE AT
THE MAYFAIR PARK





Splendour, Elegance and the Finest Fittings

The signature life is not just restricted to your living room or master bedroom. It extends to all corners of your home, including the bathroom. Embellished with branded fittings and sanitary ware, the bathroom gets converted into a showcase of fashion and style.



- Premium Vitrified Tiles in flooring & Laminated wooden flooring in Master Bedroom
- Ceiling -POP false ceiling as per design
- Modular Wardrobe in all Bedrooms
- Painted interior Wall Finishes & Textured Balcony and exterior wall finish.
- Lighting – Branded COB and Panel concealed lights (excluding studio lighting)
- Branded Electric Fittings
- Provision for Split A/C in Bedrooms, Drawing & Dining.
- Wooden TV Unit ledges in all bedrooms and living room.
- Toilets with Branded Sanitary Fixtures, Mirrors, Other CP Fittings including Vanity and glass shower panel.
- High Quality external UPVC doors and windows.

Comfort, Culinary and the Pleasure in between

A kitchen is a space where creativity in culinary skills brings out the essence of food. We have built you a kitchen filled with luxury and the comfort to let you enjoy your cooking sessions with the pleasure of owning one.



- Premium Modular kitchen Cabinets & Fittings with Pantry Unit and glass crockery unit (w/o appliances)
- Premium Vitrified Tiles up to 2ft. above counter, Premium Granite Counter Top and SS Sink
- Separate Washing Area & Storage space in balconies.
- Gas Pipeline Supply
- Designer Main Door with laminated internal doors fixed on Fire and Termite Proof WPC door frames with wooden cover moulding.
- MS Railing in Balconies with Texture painted walls and ceiling.

MAYFAIR PARK Structure

Earthquake resistant RCC Structure vetted by IIT Guwahati

MIVAN CONSTRUCTION TECHNOLOGY

Find a seamless connection of the form & function with the innovative Mivan Construction Technology. From your stunning apartments to splendid penthouses & the imposing clubhouse. MAYFAIR PARK stages perfection, commitment, and completeness.



- Higher Carpet Area



- Earthquake Resistant



- More Seismic Resistance



- Increased Durability



- Cost Effective



- Uniform Quality of Construction



- Smooth Finishing of Wall & Slab



- Reduced Leakages



- Low Maintenance



- Adaptable & Eco- Friendly

MAYFAIR PARK

Major Features



THEMATIC GARDEN



INDOOR SWIMMING
POOL



STEAM AREA



BADMINTON COURT



CHILDREN PARK &
JOGGING AREA



YOGA STUDIO



CLUB HOUSE &
MEGA GYMNASIUM



OUTDOOR LOUNGE



PARTY HALL



INDOOR & OUTDOOR
GAMING ZONE



TODDLERS'
PLAY AREA



LUSH GREEN
LANDSCAPES



International Airport
15 Km



D-Mart
500 Meter



Bus Stand PKL
5 Km



Alchemist Hospital
3 Km



Golf Course
Sector 3, Panchkula
3 km



Railway Station
6 Km



Market Sector 20,
Panchkula
1 Km



Tau Devilal Stadium
Sector 3, Panchkula
3 Km





SITE PLAN

3 BHK TYPE 1 FLOOR PLAN

87 UNITS

A 101-201, 102-1702 | B 101 - 1701 | D 101 - 1701 | D 102 - 1702 | E 101 - 1701



Carpet Area - 964.5 sq. ft. | Covered Area - 1410 sq. ft.
Balcony Area- 310 sq. ft. | Super Area- 1835 sq. ft.

3 BHK TYPE 2 FLOOR PLAN

49 UNITS

A 301-1701 | B 102 - 1702 | E 102 - 1702



Carpet Area - 964.5 sq. ft. | Covered Area - 1730 sq. ft.

Balcony Area- 650 sq. ft. | Super Area- 2180 sq. ft.

2 BHK TYPE 1 FLOOR PLAN

10 UNITS
C 501 - 1401



Carpet Area - 484.5 sq. ft. | Covered Area - 945 sq. ft.
Balcony Area- 360 sq. ft. | Super Area- 1200 sq. ft.

2 BHK TYPE 2 FLOOR PLAN

10 UNITS

C 502 - 1402



Carpet Area - 484.5 sq. ft. | Covered Area - 884 sq. ft.

Balcony Area- 300 sq. ft. | Super Area- 1140 sq. ft.

2 BHK TYPE 3 FLOOR PLAN

14 UNITS
C 103 - 1403



Carpet Area - 484 sq. ft. | Covered Area - 760 sq. ft.
Balcony Area- 188 sq. ft. | Super Area- 1015 sq. ft.

2 BHK TYPE 4 FLOOR PLAN

4 UNITS
C 101 - 401



Carpet Area - 484.5 sq. ft. | Covered Area - 781 sq. ft.
Balcony Area- 198 sq. ft. | Super Area- 1030 sq. ft.

2 BHK TYPE 5 FLOOR PLAN

4 UNITS
C 102 - 402



Carpet Area - 484.5 sq. ft. | Covered Area - 720 sq. ft.
Balcony Area- 142 sq. ft. | Super Area- 978 sq. ft.

1 BHK FLOOR PLAN

14 UNITS

C 104 - 1404



Carpet Area - 416 sq. ft. | Covered Area - 635 sq. ft.
Balcony Area- 150 sq. ft. | Super Area- 900 sq. ft.

CLUB HOUSE - FLOOR PLANS

GROUND FLOOR PLAN



BASEMENT PLAN



CLUB HOUSE - FLOOR PLANS

1ST FLOOR PLAN



2ND FLOOR PLAN



CLUB HOUSE - FLOOR PLAN

CLUB TERRACE 3RD FLOOR PLAN

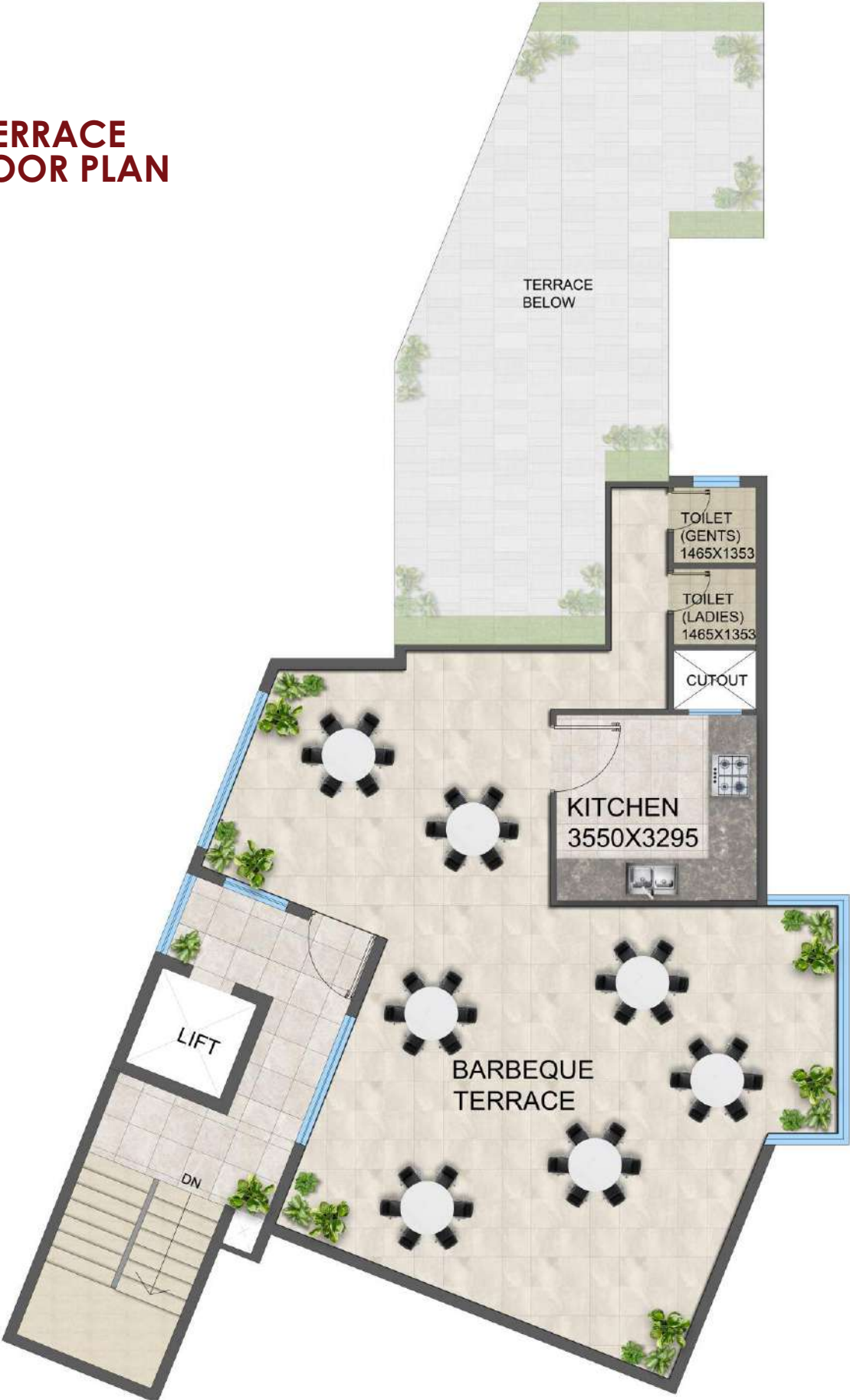



MAYFAIR PARK

(M) +91 98759 04201, 0172-2992875

(E) office.nanditazkp@gmail.com

(W) www.mayfairpark.in



Scan QR Code for Location

Project Site : Adjoining Sector-20,
Panchkula, Kishanpura, Zirakpur (Pb.)

Disclaimer: This brochure is purely conceptual and do not constitute a legally binding offer. All images are artist's impressions and not necessarily fully representative. In the interest of maintaining high standards, the contents herein, including all services, infrastructure, products, designs, amenities, facilities, site plans, layout plans, floor plans, areas, dimension, specifications, elevations, and perspectives views are tentative in nature and are subject to variations and modifications, without notice, till the final completion of the project, at the sole discretion of Competent, Statutory Authorities or the Company. Architectural features may differ in different apartments.
All images are an artistic conceptualization and does not purport to replicate the exact products.